

Air Cylinder/Compact Type

RoHS

Size: 40, 63

Now, more compact and lightweight due to the adoption of a octagonal piston!

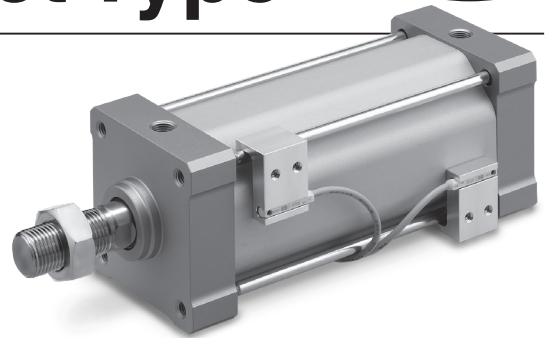

Weight **35 % reduction**
750 g → 487 g

Overall length **16 % reduction**
189 mm → 158 mm

Height Width **10 % reduction**
52 mm → 47 mm

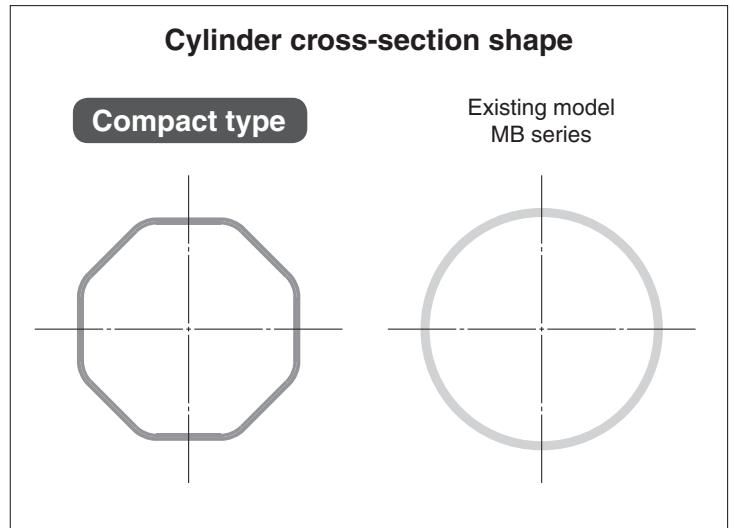

* Compared with the MB series, Ø 40, 50 mm stroke

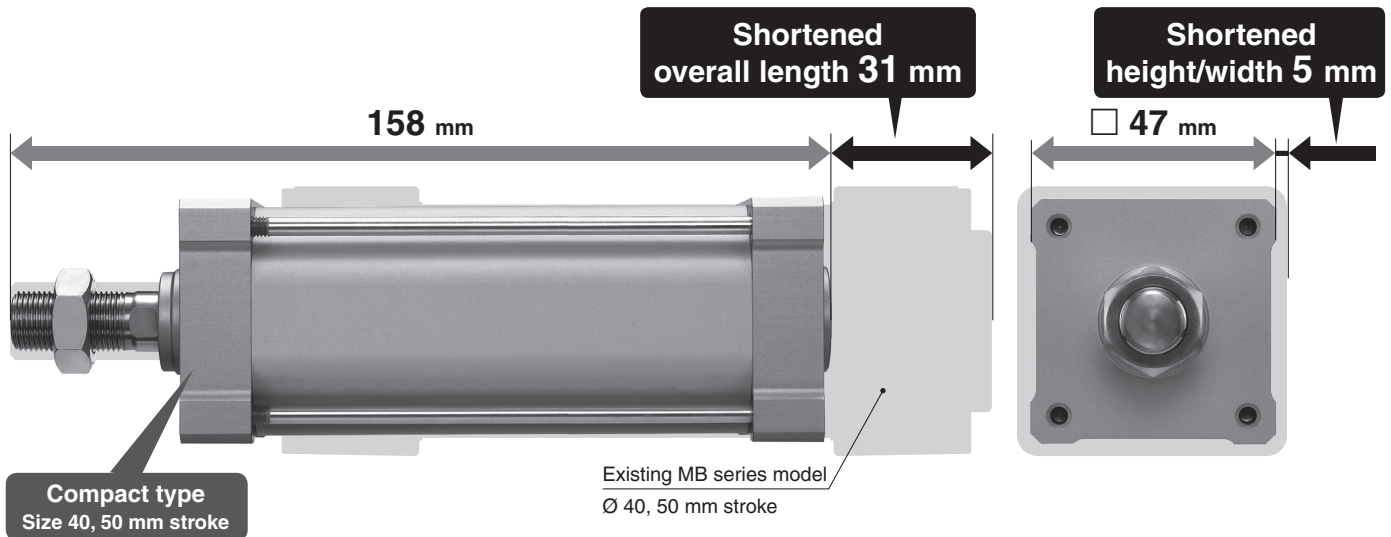

■ Small auto switches can be mounted on 4 surfaces. (Tie-rod mounting)

Applicable auto switch: D-M9□

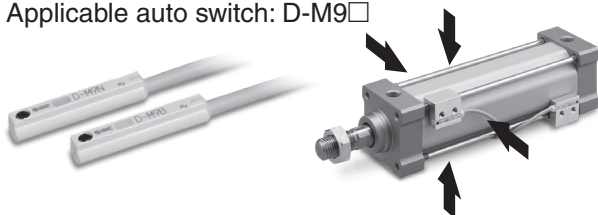

■ Air cushion adjustment is not required due to the non-adjustable air cushion.

The built-in rubber bumper reduces the metal noise that occurs when the piston stops.

■ Cover shape that prevents foreign matter accumulation

MB-X3155



19-EU728-UK

MB-X3155

Specifications

Size	40 (Equiv. Ø 40 piston area) 63 (Equiv. Ø 63 piston area)
Action	Double acting, Single rod
Proof pressure	1.0 MPa
Max. operating pressure	0.7 MPa*1
Min. operating pressure	0.05 MPa
Ambient and fluid temperatures	5 to 60 °C
Lubrication	Not required (Non-lube)
Piston speed	50 to 500 mm/s*1
Stroke length tolerance	$^{+2.0}_0$ mm
Cushion	Non-adjustable air cushion + rubber bumper
Port size	Rc1/8
Stroke	50 to 250 mm (25 mm increments)
Mounting	None (Basic type only)
Allowable kinetic energy	1.2 J 3.4 J

Depending on the system configuration selected, the specified speed may not be satisfied.

*1 Maximum operating pressure and piston speed are different from the existing product (MB series).

Standard Strokes

Size	Standard stroke [mm]
40	50, 75, 100, 125, 150,
63	175, 200, 225, 250

Theoretical Output

			Operating pressure [MPa]						
Size	Rod operating direction	Piston area [mm ²]	0.2	0.3	0.4	0.5	0.6	0.7	[N]
40	IN	1108	222	332	443	554	665	776	
	OUT	1262	252	379	505	631	757	884	
63	IN	2858	572	857	1143	1429	1715	2000	
	OUT	3112	622	934	1245	1556	1867	2178	

* Theoretical output [N] = Pressure [MPa] x Piston area [mm²]

Dimensions

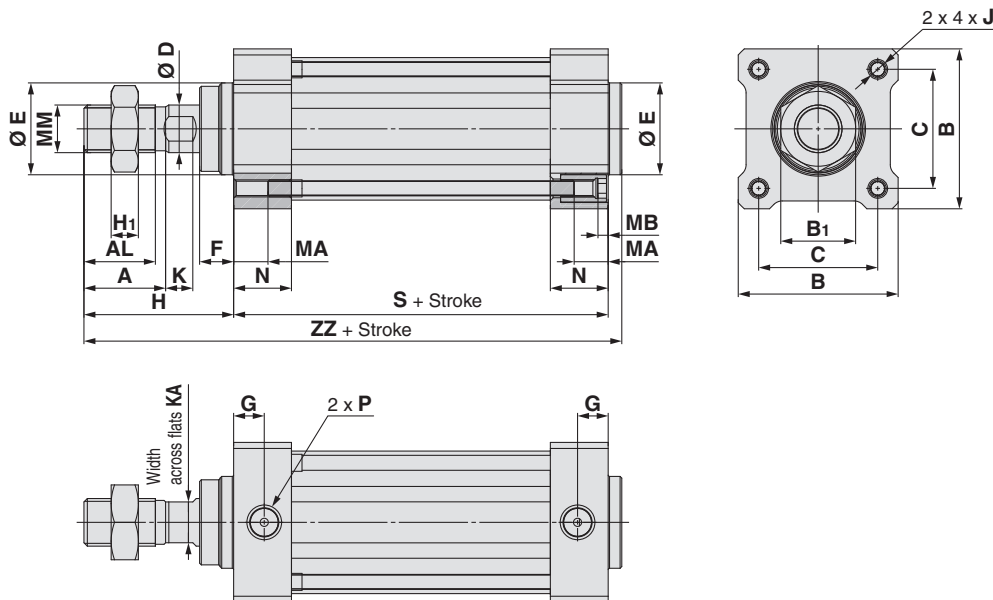

Auto switch bracket dimensions

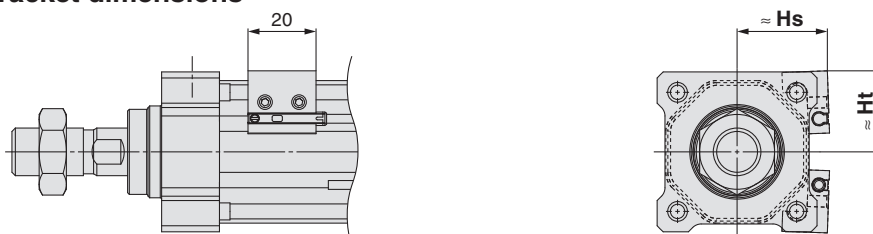

Size	A	AL	B	B1	C	D	E	F	G	H	H1	J	K	KA	MA	MB	MM	N	P	S	ZZ	Hs	Ht
40	24	21	47	22	35	14	27	10	9	44	8	M5 x 0.8	8	12	9	3	M14 x 1.5	17	Rc1/8	60	108	26.5	23.8
63	35	32	69	27	53	18	31	8	11	51	11	M6 x 1.0	7	16	10	3.5	M18 x 1.5	20	Rc1/8	67	122	40.4	32.5

SMC Corporation (Europe)

SMC Corporation
Akihabara UDX 15F, 4-14-1, Sotokanda, Chiyoda-ku, Tokyo 101-0021, JAPAN
Phone: 03-5207-8249 Fax: 03-5298-5362
SMC CORPORATION All Rights Reserved

Printing YP 00 Printed in Spain

European Marketing Centre (EMC)

Zuazobidea 14, 01015 Vitoria
Tel: +34 945-184 100 Fax: +34 945-184 124
URL <http://www.smc.eu>

Specifications are subject to change without prior notice and any obligation on the part of the manufacturer